

The Sentry® 381.47 is an outward opening, pre-hung door and jamb set.

The single door leaf has an VH grade 35mm polystyrene core surrounded by an internal sub-frame made of kiln-dried hoop pine (42x35mm). It includes hardware fixing points (300x140mm) for the closer and lock blocks with a 1.5mm Galvaneal insert between the core and the inner skin and is fully enclosed on faces and sides with two 0.5mm Colorbond steel sheets, fixed with a two-part polyurethane adhesive.

The door jamb has a four-sided profile made of multi-folded, pressed and welded 1.5mm steel, powder-coated to match the Colorbond of the door leaf, or to another colour of your choice.

The door and jamb are fastened together with heavy-duty metal screws at 4 welded butt hinges (100x75x2.5mm).

The door is supplied with a deadbolt and standard lock preparation of 54mm, and 70mm back set.

AVAILABLE SIZES:

- » 2040mm (h) x 820mm (w)
- » 2040mm (h) x 920mm (w)

APPLICATIONS:

Steel structures, including garages, domestic shed and farm sheds.

AVAILABLE COLOURS:

Available in the complete classic & contemporary ranges of COLORBOND® steel colours.

ADDITIONAL FINISHES:

- » Colorbond® Matt
- » Colorbond® Ultra
- » Galvanised Steel
- » Zinccaneal® Steel
- » Metaprep Primer for corrosive environments

WIND RATING:

100.1
M/S (360.36 KM/H)



TESTED IN ACCORDANCE WITH AS/NZS 1170.2:2011

Sentry® 381.47 doors are tested and approved for use in all of regions A, B, C and D, as per the Australian Standard. That means they are certified to withstand cyclonic winds.

SUPPLIED IN SET

- » Pre-Hung Door and Jamb
- » Locksets
- » Cardboard packers between door and jamb

A. PRODUCT CHECK AND SITE

Note: Keep the door packers in place until the door is fully fitted.

Required: Cutting tool and framing materials for structure cladding.

1. Check your door and jamb set for quality and craftsmanship.
 - ▶ If there is damage or fault, contact your supplier immediately.
 - ▶ **Note:** If you proceed to install a door, the opportunity to claim a replacement on the basis of damage or fault will be limited.
2. Decide where your door goes.
 - ▶ A Trimdek or Monoclad profile is ideal.
 - ▶ All corners of the cut must be safely in the valley of the cladding profile.
 - ▶ Ensure there is no structural steel behind the planned cut area.
3. Cut the required opening out of the cladding.
 - ▶ The required size depends on the size of the door to be installed.

381.47.820	
DOOR SIZE	2040mm (h) x 820mm (w)
REQ. OPENING	2055mm (h) x 840mm (w)
381.47.920	
DOOR SIZE	2040mm (h) x 920mm (w)
REQ. OPENING	2055mm (h) x 940mm (w)

4. Extend the horizontal cut across the top about 50mm beyond the intersection with each vertical cut (see Fig. 6).
 - ▶ This extended cut allows the top architrave (and optional J-mould weather strip) to slide behind the shed cladding.
5. Frame out your door opening with the materials recommended for your shed/garage.

B. DOOR SET INSTALLATION

Required: Spirit level, impact driver, at least six (6) screws of 10 gauge or larger.

Note: Keep the door packers in place until the door and jamb set is fully fitted.

1. Lift the door and jamb set into place (see Fig. 4).
 - ▶ Start from outside of the structure.
 - ▶ Use two (2) people to lift.
2. Insert the top of the jamb into the cladding.
 - ▶ Align the top architrave of the jamb with the extended horizontal cut in the cladding.
 - ▶ Slide the top of the jamb through the extended cut, fitting the architrave between the structure cladding and the mullions.
3. (Optional) Cut the j-mould weather strip (sold separately) to the desired length and slide in between the jamb architrave and the structure cladding. The recommended minimum length for the j-mould weather strip should be the width of the jamb from outside to outside.

Note: J-moulds are more effective when slightly lower at one side.

4. Screw hinge side of door (see Fig. 1).
 - ▶ Work on the outside of the structure.
 - ▶ Position screws no more than 40mm from the hinge knuckle.
 - ▶ Ensure screws will go through door jamb and mullions.
 - ▶ **First screw:** by the top hinge.
 - ▶ **Second screw:** by the bottom hinge.
 - ▶ **Third screw:** by the middle hinge.
 - ▶ Hold the door steady with one hand.
 - ▶ Insert and tighten each screw with an impact driver.
 - ▶ Take care that the door does not move while screwing.

▶ After each screw, check the stile is square and plumb.

Adjust as needed before proceeding.

5. Screw off the latch-side of the door in the same way, at equal heights.
 - ▶ Top screw, bottom screw, middle screw, in that order.
 - ▶ Check that the jamb remains square/plumb before each screw.
 - ▶ If the door set drops under its own weight before fully screwed, carefully correct it before screwing off.
6. (Optional) If screwing has caused any distortion of the frame, additional screws may be put through the internal return fold to affix it into shape.

C. AFTER DOOR INSTALLATION

After the door set is fixed in place:

1. Remove packers from the door.
2. Peel back the protective covering surrounding the lock preps.
3. Fit the supplied locksets.
4. Remove the protective covering from surfaces. (The longer it remains on, the harder it may be to remove cleanly.)

D. AFTER CARE

To get the most out of your investment, cleaning should occur:

- ▶ In rural or normal urban environments, every six (6) months.
- ▶ In areas of high pollution, such as industrial areas or coastal environments, every three (3) months.
- ▶ In particularly hazardous or corrosive environments such as beachfronts, severe marine environments, areas of high industrial pollution, monthly.

Hinges, Locks, and furniture should also be regularly inspected and cleaned in accordance with the above schedule.

DO NOT use harsh solvents, abrasive cleaners (turps, petrol, kerosene, paint thinners) or scourers on any products. Carry out cleaning in shade and during cooler temperatures using a soft cloth and gentle wiping only.

We recommend that your locks only be serviced by a qualified locksmith.

PRODUCT FILE CODE	DOOR SIZE HxW	DOOR THICKNESS (MM)	OVERALL PRODUCT INSERT HxW	OVERALL EXT. ARCHITRAVE HxW	OVERALL INT. ARCHITRAVE HxW	REVEAL FOR DOOR HxW	CLEAR OPENING REQUIRED HxW	OPENING SIZE HxW	DOOR OPENING ANGLE	WIND RATED TO REGION
381.47.820	2040 x 820	38	2052 x 837	2136 x 924	-	2050 x 828	2018 x 798	2055 x 840	180°	D
381.47.920	2040 x 920	38	2052 x 937	2136 x 1024	-	2050 x 928	2018 x 898	2055 x 940	180°	D

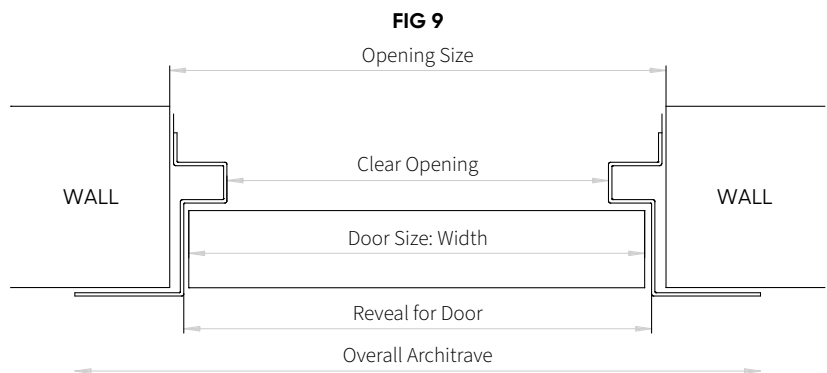
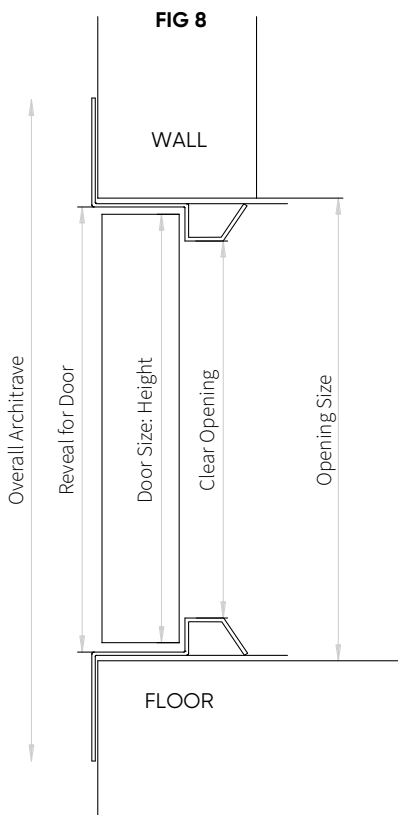

Correct as at 11/08/23

KNOW YOUR HANDING

'Handing' describes where the hinges are on a door that is opening towards you. When you order a new door, it is important to know its handing so that it suits your installation.

HOW DO YOU TELL?

If you open a door towards you and the hinges are on your left, the door is **left-hand hinged**.

If you open a door towards you and the hinges are on your right, the door is **right-hand hinged**.

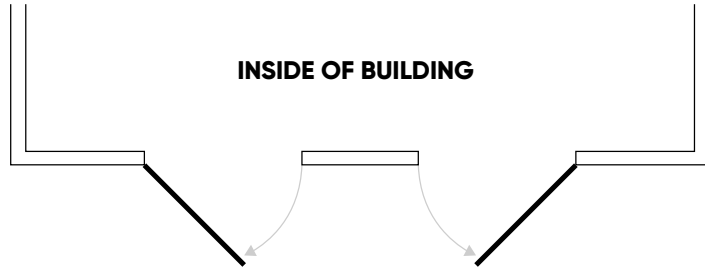

OUTSIDE OF BUILDING

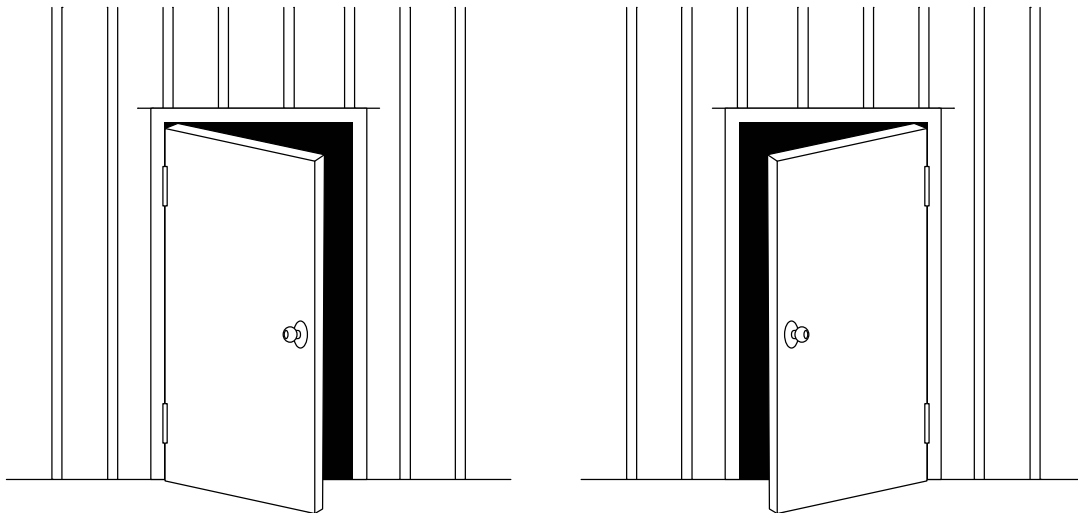

Correct as at 11/08/23

Larnec Doors provide a 24 month warranty on all products. The warranty does not cover the product if incorrectly installed, used or maintained, damage from environmental conditions, fair wear and tear, accidents or salt corrosion.